

EQUIPMENTS FOR BIG TILES/SLABS UP TO 426x156 cm - (14'x5.2')



CUTTING SYSTEM FOR SLABS

S2 FREE-CUT: GUIDES FOR CUTTING BIG TILES/SLABS

ACCESSORIES AND SPARE-PARTS FOR FREE-CUT

S3 FREE-FLEX 90°: COMPLETE CUTTING UNIT WITH ANGLE GRINDER FOR FREE-CUT FOR 90° CUT

S3 FREE-FLEX 35°/55°: COMPLETE CUTTING UNIT WITH ANGLE GRINDER FOR FREE-CUT FOR 35°/55° CUT

S3 CUTTING-OFF PLIERS FOR MATERIAL OF THICKNESS FROM 6 UP TO 12 mm (1/4" - 1/2")

S3 VACUUM SUCTION KIT FOR FREE-CUT

SYSTEMS FOR HANDLING BIG/TILES SLABS

S4 EASY-MOVE

S5 EASY-MOVE VACUUM

S6 ACCESSORIES FOR EASY-MOVE AND EASY-MOVE VACUUM

S7 FREE-MOVE

WORK BENCH AND MODULAR TROLLEY

S8 CAM300: MODULAR TROLLEY

S9 BM180: MODULAR BENCH

TOOLS FOR BIG TILE & SLABS

S10 CLOSER: DEVICE TO ACCOST TILES/SLABS

S10 RUBBER ANTI-BOUNCING TILE BEATER

S10 DIAMOND PADS

S10 DIAMOND PADS FOR EDGE AGLE GRINDER

The most complete equipment for the most innovative ceramic slabs. The "Free-Cut" guides perform perfect cut on slabs up to a maximum length of 426 cm (14'). Furthermore, by applying on "Free-Cut" guides the special cutting units with angle grinder ("Free-Flex"), even the most difficult cut is no longer a problem. "Free-Flex" allows to perform cut (with diamond discs) at 90° or 45° not only on thin slabs (3 to 6 mm - 1/8" - 1/4"), but also on regular thickness materials (up to 12 mm - 1/2"), whether they are in porcelain or natural stone. For handling large slabs the "Easy-move" and "Free-Move" systems offer the ideal solution for every need. The modular bench "BM180" has been instead designed to provide an easy to transport as well as efficient worktop while the modular trolley "CAM300" is perfect for transporting slabs. In addition to this, we have developed other equipment specific for the installation and processing of these innovative ceramic materials such as the rubber float to expel the air below the slab and improve the bounding of the adhesive, "Closer" the device to accost slabs and a line of diamond tools for finishing and polishing the edges and sides after cutting. For further information: raimondispa.com/freeline/



FREE-CUT – CUTTING SYSTEM FOR SLABS UP TO 426x156 cm (14'x5.2')



ACCESSORIES



PACKAGE



FREE-CUT – CUTTING SYSTEM FOR SLABS UP TO 426x156 cm (14'x5.2')

- Guides for cutting big tiles/slabs up to 426x156 cm (14'x5.2')
- To reach the maximum cutting length you need to combine the "Free-Cut" complete guide with one extension guide.
- Dismountable for the ease of handling.
- Made in anodized aluminum and galvanized steel.
- The guides are properly fixed to the slab thanks the Ø 120 mm (4 3/4") suckers.
- For use on textured materials apply the vacuum suction cups kits; art. 169GP (accessory).

FREE-CUT COMPLETE GUIDES

- Guides for cutting big tiles/slabs up to max length of 156 cm (5.2') - art. 169FC150N or 206 cm (6.8') - art. 169FC200N.
- Increase cutting length up to 426 cm (14') by adding extension.
- Provided with cutting-off pliers for tile/slab with max thickness of 6 mm (1/4").
- Provided with complete cutting-unit (wheel Ø 12 mm - 1/2" included).
- Provided with side squares.
- Provided with carrying case for pliers, cutting-unit and side squares.
- Provided with suckers Ø 120 mm (4 3/4") for best fitting to the slab.
- For use on textured materials apply the vacuum suction cups kits; art. 169GP (accessory).
- Implementable with "Free-Flex": cutting unit with angle grinder.

SPECIFICATIONS AND VERSIONS

Part No.	Barcode	Box	Description	Without extension	With extension 170cm-5.6'	With extension 220cm-7.2'	Weight	Dimensions	Weight
169FC150N	8024648081094	1	"Free-Cut" guide with complete outfit (max cut length 5.2')	156 cm 5.2'	326 cm 10.7'	376 cm 12.3'	11 Kg 24.3 lbs	180x Ø17 cm + 39x39xh 14 cm 71" x Ø7" + 15 3/8" x 15 3/8" x h 5 1/2"	13 Kg 28.6 lbs
169FC200N	8024648085528	1	"Free-Cut" guide with complete outfit (max cut length 6.8')	206 cm 6.8'	376 cm 12.3'	426 cm 14'	15 Kg 33 lbs	227x Ø17 cm + 39x39xh 14 cm 89" x Ø7" + 15 3/8" x 15 3/8" x h 5 1/2"	18 Kg 39.6 lbs

FREE-CUT EXTENSIONS

- Extensions to combine with the "Free-Cut" complete guide to reach desired cutting length.
- Available in two versions: length 170 cm (5.6') - art. 169FC150PN; length 220 cm (7.2') art. 169FC200PN.
- Supplied without cutting-off pliers, without cutting-unit and without side squares.

Part No.	Barcode	Box	Description	Length	Weight	Dimensions	Weight
169FC150PN	8024648084934	1	"Free-Cut" extension ; length 170 cm (5.6')	170 cm 5.6'	8 Kg 17.6 lbs	180x Ø17 cm + 39x39x h14cm 71" x Ø7" + 15 3/8" x 15 3/8" x h 5 1/2"	10 Kg 22 lbs
169FC200PN	8024648084958	1	"Free-Cut" extension ; length 220 cm (7.2')	220 cm 7.2'	12 Kg 26.4 lbs	227x Ø17 cm + 39x39x h14cm 89" x Ø7" + 15 3/8" x 15 3/8" x h 5 1/2"	15 Kg 33 lbs



MADE IN ITALY



169GTE 230V



169GTJ 230V



169TR01A



169TM01A



169GTE OH



169GTJ OH



169GP



FREE-FLEX 90° - 90° CUTTING UNIT WITH ANGLE GRINDER FOR FREE-CUT

- To be mounted on cutting guides FREE-CUT (max length of cut: 425 cm - 13.9') for performing 90° cuts.
- Tilting movement (plunge cut) to adjust the depth of cut and to make cuts in multiple passes as well as to perform cut in the middle of the slab, square and rectangular holes.
- Depth of cut: 25 mm (1") with disc Ø 150 mm (6"); 15 mm (3/8") with disc Ø 125 mm (5").

- Equipped with semi-universal attachment: compatible with the most popular brands and models of angle grinders.
- Provided with clutch hose for dust extraction.
- Dry cut with diamond blade.
- Disc Ø: min 125 mm (5"); max 150 mm (6").

FREE-FLEX 35°/55° - 35°/55° VARIABLE ANGLE CUTTING UNIT WITH ANGLE GRINDER FOR FREE-CUT

- To be mounted on cutting guides FREE-CUT (max length of cut: 425 cm - 13.9').
- Provided with tilting system to miter angle between 35° and 55° on slabs of length up to 426 cm (14').
- Depth of cut: 20 mm (3/4") with disc Ø 150 mm (6"); 15 mm (5/8") with disc Ø 125 mm (5").
- Equipped with semi-universal attachment: compatible with the most popular brands and models of angle grinders.

- Provided with clutch hose for dust extraction.
- Dry cut with diamond blade.
- Disc Ø: min 125 mm (5"); max 150 mm (6").

SPECIFICATIONS AND VERSIONS

Part No.	Barcode	Box	Description	Power	Icon	Dimensions	Weight
169GTE 230V	8024648082527	1	"FREE-FLEX 90°" Plunge-cut unit 90° with angle grinder 850W 230V 50/60 Hz and continuous rim diamond disc Ø 150 mm (6"). Semi-universal attachment.	230V 50/60 Hz	90°	40x28x h25 cm 16"x11"x h10"	6,8 Kg 15 lbs
169GTE OH	8024648086457	1	Plunge-cutting unit 90° without angle grinder. Semi-universal attachment: compatible with the most popular brands and models of angle grinders.	-		16"x11"x h10"	3,2 Kg
169GTJ 230V	8024648086471	1	"FREE-FLEX 35°/55°" Variable angle 35°/55° cutting unit with angle grinder 850W 230V 50/60 Hz and turbo diamond disc Ø 125 mm (5"). Semi-universal attachment.	230V 50/60 Hz	35/55°	40x28x h25 cm 16"x11"x h10"	5,8 Kg 15 lbs
169GTJ OH	8024648083173	1	35°/55° variable angle cutting unit without angle grinder. Semi-universal attachment: compatible with the most popular brands and models of angle grinders.	-		16"x11"x h10"	3,5 Kg
179CCT125	8024648075703	1	Turbo diamond disc Ø 125 mm (5") for "Free-Flex"	-	-	-	-
179CC150SE	8024648087171	1	Continuous rim diamond disc Ø 150 mm (f 22,2 mm) for "FREE-FLEX"	-	-	-	-

OTHER ACCESSORIES AND SPARE PARTS FOR FREE-CUT

Part No.	Barcode	Box	Description	Dimensions	Weight
169TM01A	8024648067470	1	Cutting-off pliers for tile/slab with thickness up to 6 mm	-	2 Kg - 4.4 lbs
169TR01A	8024648078063	1	Cutting-off pliers for tile/slab with max thickness of 6 mm (1/4")	-	-
13512A	8024648079824	1	Wheel Ø 12 mm (1/2") with pin	-	-
135D16A	8024608083630	1	Wheel Ø 16 mm (5/8") with pin	-	-
169GP	8024648086037	1	Pair of vacuum suction cups kits for "FREE-CUT"	33x33xh10 cm	4,1 Kg - 9 lbs

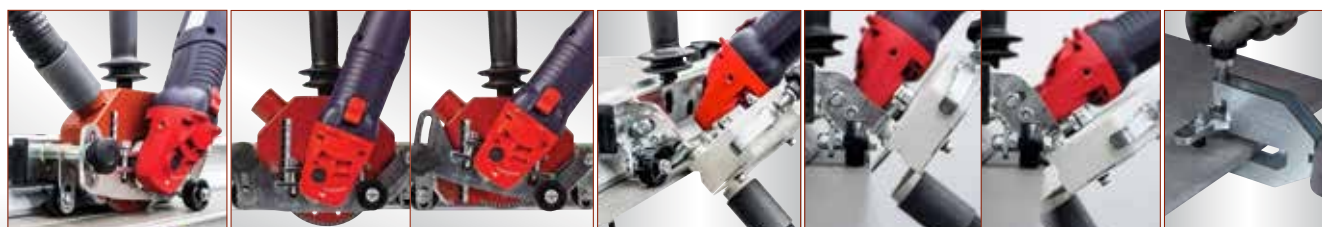

EQUIPMENTS FOR BIG TILES/SLABS UP TO 426X156 cm - (14'x5'.2')

EASY-MOVE AND DOUBLE EASY-MOVE WITH CROSSBARS

MADE IN ITALY

YouTube
spazio design
 raimondispa

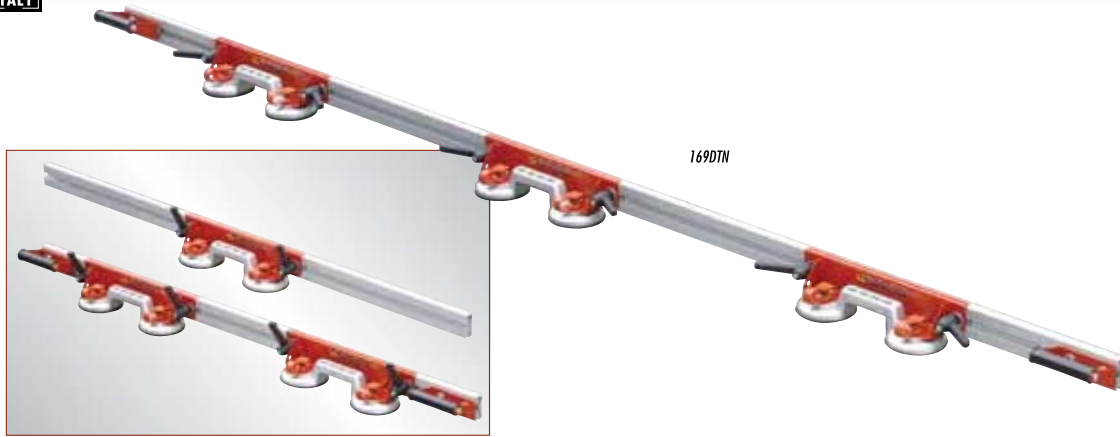

169DTN

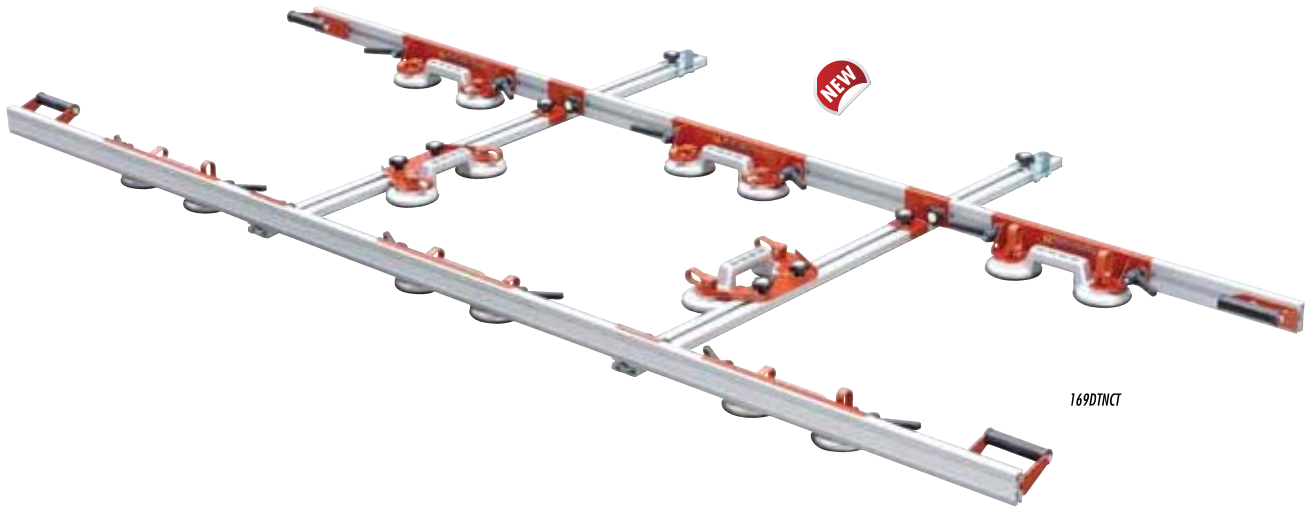

169DTNCT

NEW

ACCESSORIES FOR EASY-MOVE



PACKAGE



EASY-MOVE - DEVICE FOR HANDLING LARGE FORMAT SLABS (MAXIMUM 300x150 cm - 10'x5')

- EASY-MOVE is the device for pulling the slabs up from the crates / pallets and for smoothly and safely handle them.
- It is composed of two guides, easily connectable for handling slabs of maximum length of 300 cm (10').
- For slabs of maximum length of 150 cm (5') only a single guide is needed.
- It's lightweight and easy to carry thanks to the modularity in two separate guides.

- It's equipped with 3 bi-suction cup kits (6 cups total of Ø 120 mm).
- For textured surfaces (not smooth) use vacuum suction cups (optional) instead.
- For handling slabs of 150x300 cm (10'x5'), in order to have an optimal weight distribution, it is recommended to use 2 EASY-MOVE or the DOUBLE EASY MOVE with crossbars.
- The standard EASY-MOVE can be improved adding extra crossbars and vacuum suction cup kits (optional).

DOUBLE EASY-MOVE WITH CROSSBARS - DEVICE FOR HANDLING LARGE FORMAT SLABS (MAXIMUM 300x150 cm - 10'x5')

- DOUBLE EASY-MOVE is the optimum solution for safely handle slabs on which even large notches-cuts and/or hole-cuts have been performed.
- It is composed of two EASY-MOVE and 2 crossbars equipped with an extra bi-suction cup kit each.
- It can handle slabs of 150x300 cm (10'x5').
- Each crossbar is provided with safety hook.

- Equipped with 8 bi-suction cup kits (16 cups total of Ø 120 mm).
- For textured surfaces (not smooth) use vacuum suction cup kits (optional) instead.
- It is light, simple and quick to assemble/disassemble for easy transport.
- The standard DOUBLE EASY-MOVE with crossbars can be improved adding extra vacuum suction cup kits (optional).

SPECIFICATIONS AND VERSIONS

Part No.	Barcode	Quantity	Description	Weight	Dimensions	Volume	Weight
169DTN	8024648081513	1	"EASY-MOVE"	13,5 Kg 29.7 lbs	140x Ø17 cm+40x40xh 15 cm	55" x Ø 7" +15 3/4" x 15 3/4" xh 6"	14,5 Kg 32 lbs
169DTNCT	8024648085665	1	"DOUBLE EASY-MOVE" with crossbars	38 Kg 84 lbs	135x42xh 28 cm	53" x 16 1/2" xh 11"	41,5 Kg 91.4 lbs



EQUIPMENTS FOR BIG TILES/SLABS UP TO 426X156 cm - (14'x5.2')



169DTE



169DTECT

ACCESSORIES FOR EASY-MOVE VACUUM



CROSSBARS

PACKAGE



CARTON BOX

EASY-MOVE VACUUM - DEVICE FOR HANDLING LARGE FORMAT SLABS (MAXIMUM 300x150cm - 10'x5')

- EASY-MOVE VACUUM is equipped with 2 vacuum suction cup kits (cup Ø 150 mm), it's the optimum choice for smoothly and safely handle slabs with textured surface (not smooth).
- It is the device for pulling the slabs up from the crates/pallets and for smoothly and safely handle them.
- It is composed of two guides, easily connectable for handling slabs of maximum length of 300 cm (10').
- For slabs of maximum length of 150 cm (5') only a single guide is needed.
- Lightweight and easy to carry thanks to the modularity in two separate guides.

- For handling slabs of 150x300 cm (10'x5'), in order to have an optimal weight distribution, it is recommended to use 2 EASY-MOVE VACUUM or the DOUBLE EASY MOVE VACUUM with crossbars.
- Each suction cup is equipped with a manual pump to create vacuum, it is provided with an indicator that shows when the suction is losing grip as well as a release button to quickly break the suction hold.
- The standard EASY-MOVE VACUUM can be improved adding extra crossbars (optional).

DOUBLE EASY-MOVE VACUUM WITH CROSSBARS - DEVICE FOR HANDLING LARGE FORMAT SLABS (MAXIMUM 300x150cm - 10'x5')

- DOUBLE EASY-MOVE VACUUM is equipped with 6 vacuum suction cup kits (cup Ø 150 mm), it's the optimal choice for smoothly and safely handle slabs with textured surface (not smooth).
- It is designed for safely handle slabs on which even large notches-cuts and/or hole-cuts have been performed.
- DOUBLE EASY-MOVE VACUUM is composed of two EASY-MOVE VACUUM and two crossbars equipped with an extra vacuum suction cup kit each.

- It can handle slabs of 150x300 cm (10'x5').
- Each crossbar is provided with safety hook.
- It is light, simple and quick to assemble/disassemble for easy transport.
- Each suction cup is equipped with a manual pump to create vacuum, it is provided with an indicator that shows when the suction is losing grip as well as a release button to quickly break the suction hold.

SPECIFICATIONS AND VERSIONS

Part No.	Barcode	Qty	Description	Weight (Kg)	Weight (lbs)	Dimensions (cm)	Dimensions (in)	Weight (Kg)	Weight (lbs)
169DTE	8024648085702	1	"EASY-MOVE VACUUM"	13,7	30.2	140xØ 17+ 40x40xh15	55"xØ 7"+15 3/4"+ 15 3/4"xh 6"	17,2	37.9
169DTECT	8024648085719	1	"DOUBLE EASY-MOVE VACUUM" with crossbars	39,4	86.8	135x42xh28	53"x16 1/2"xh 11"	42,9	94.5

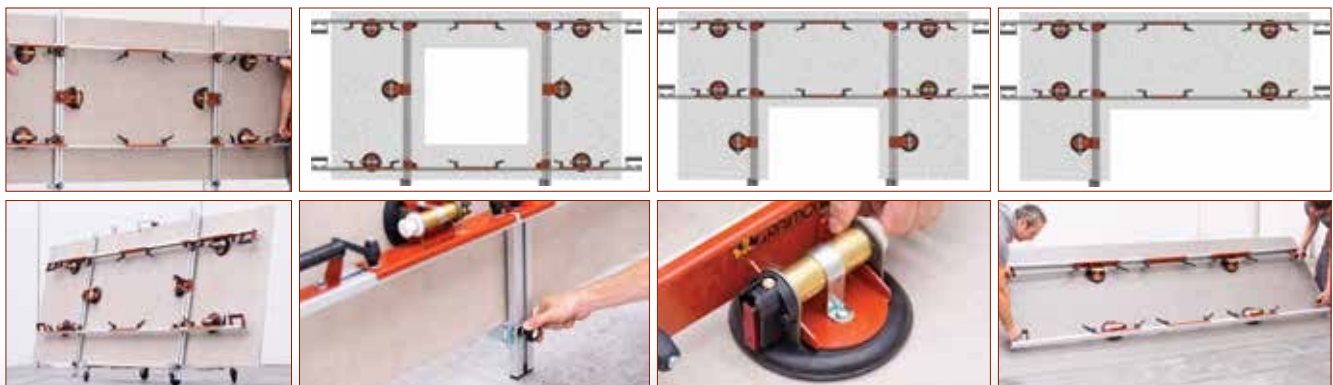

ACCESSORIES FOR EASY-MOVE AND EASY-MOVE VACUUM

MADE IN ITALY



ACCESSORIES FOR EASY-MOVE AND EASY-MOVE VACUUM

Part No.	Barcode	Quantity	Description	Weight (Kg)	Weight (lbs)	Dimensions (cm)	Dimensions (in)	Weight (Kg)	Weight (lbs)
169DTEKV	8024648085733	1	Vacuum suction kit "EASY-MOVE" (pair)	7,2	15.8	40x40x15	15 3/4"x15 3/4"xh 6"	7,5	16.5
169DTN35A	8024648085849	1	Crossbars for "EASY-MOVE" and "EASY-MOVE VACUUM" (pair)	7,5	16.5	140xØ17	55"xØ 6 5/8"	9,3	20.5
169DTN04AC	8024648085740	1	Pair of bi-suction cups kits for crossbars	3	6.6	33x33x10	13"x13"xh 4"	3,5	7.7
169DTN32AC	8024648085795	1	Pair of vacuum suction cups kits for crossbars	4	8.8	33x33x10	13"x13"xh 4"	4,5	9.9

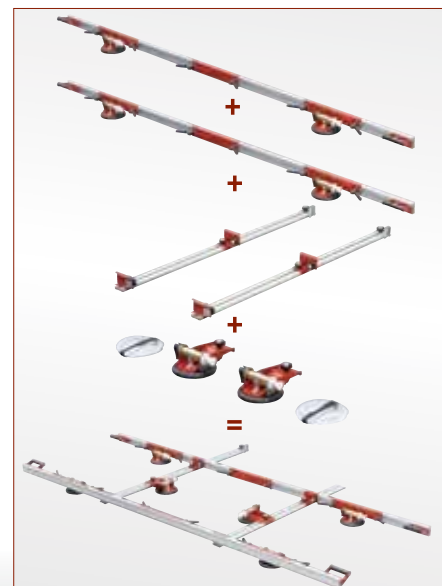
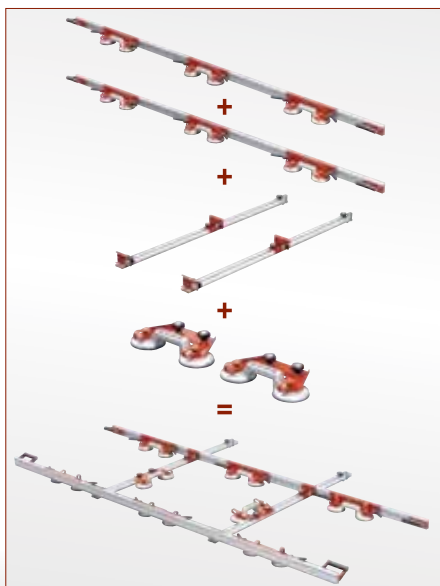

EQUIPMENTS FOR BIG TILES/SLABS UP TO 426X156 cm - (14'x5.2')

MADE IN ITALY

YouTube
channel
raimondipa



2 "FREE-MOVE" combined

FREE-MOVE

ACCESSORIES



FOAM WASHER

PACKAGE



CARTON BOX

FREE-MOVE - SYSTEM FOR HANDLING BIG/TILES SLABS UP TO 300x160 cm (10'x5'3")

- System for handling big/tiles slabs up to 300x160 cm (10'x5' 3").
- It allows to take the slabs out of the crates with ease and safety.
- Thanks to the trolleys it allows to handle the slabs with ease.
- It allows to hold the slab in vertical position for applying adhesive on the back with ease.
- Supplied with 8 suckers Ø 120 mm (4 ¾")
- Equipped with safety hooks to prevent the slab fall in case of prolonged stay on the device.
- To handle slabs sized 300x150cm (10'x5') it is required to connect 2 "Free-Move" together.

SPECIFICATIONS AND VERSIONS

Part No.	Barcode	Quantity	Description	Weight	Dimensions	Volume
169DTL150	8024648078650	1	"Free-Move" with trolley. Max tile/slab size: 5' 3"x5' 3" (increase to 10'x5' 3" combining an additional "Free-Move")	30 Kg / 66 lbs	65x95xh30 cm / 25 1/2"x37 1/2"xh12"	32 Kg / 70.5 lbs



CAM300 - MODULAR TROLLEY FOR LARGE FORMAT SLABS

MADE IN ITALY

NEW



394 MAXI



"CAM300" disassembled

PACKAGE



CARTON BOX

CAM300 – MODULAR TROLLEY FOR LARGE FORMAT SLABS

- Modular trolley designed for the transport of one or more slabs (300x150 and larger - 10'x5').
- Thanks to its design and the aluminum components, "CAM300" is light, simple and quick to assemble / disassemble and it requires little space for storage.
- "CAM300" comes with two telescopic hooks for holding our "EASY-MOVE", device for handling large format slabs, with the slab fasten on it. This makes easy and safe the operation of spreading the adhesive on the back of the slab (back-buttering).
- Telescopic safety hooks to prevent slabs to fall.
- Slab support bar with rubber protection.
- Wooden support plane.
- Lockable wheels.

SPECIFICATIONS AND VERSIONS

Part No.	Barcode	Box Icon	Description	Weight Icon	Weight	Dimensions Icon	Dimensions	Weight Icon	Weight
169CML	8024648078865	1	"CAM300" trolley for the transport of slabs		24 Kg 52.8 lbs		135x42xh28 cm 53 1/8"x16 1/2"xh 11"		27,5 Kg 60.6 lbs



EQUIPMENTS FOR BIG TILES/SLABS UP TO 426X156 cm - (14'x5.2')



394 MAXI



"BM180" disassembled



2 "BM180" combined



BM180 - MODULAR BENCH

- It is easy to disassemble and once not mounted it has small dimensions. This make it easy to transport.
- Easy to mount.
- The steel structure and the worktop made of anodized aluminum profiles guarantee sturdiness and stability.
- Legs provided with adjustable rubber feet.

- Provided with adjustable anodized aluminum profiles so to avoid them to interfere with diamond disc if cutting slabs with angle grinder.
- Worktop dimensions: 180 x 90 cm (3'x6'). Height: 83 cm (32 3/4").
- Provided with special connection devices to join more "BM180" so to expand worktop dimensions.
- Combining two "BM180" the resulting worktop dimensions are 360 x 90 cm (11.8'x6'): perfect for 300 cm (10') slabs.

SPECIFICATIONS AND VERSIONS

Part No.			Description			
394 MAXI	8024648083838	1	"BM180" - modular bench	31 Kg 68.3 lbs	190x20x h 20 cm + 110x20x h 20 cm 75"x8"x h 8" + 43"x8"x h 8"	35 Kg 77 lbs

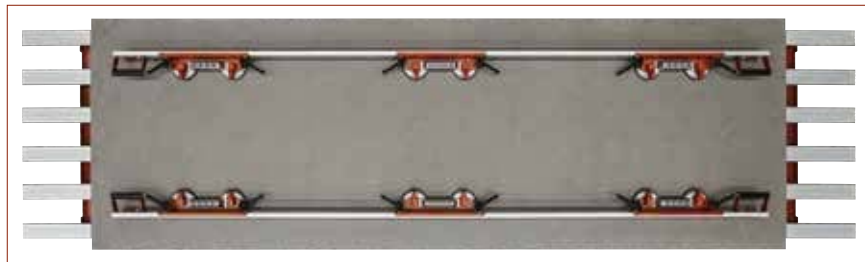

TOOLS FOR BIG TILE & SLABS

MADE IN ITALY



185DAL01A



142G

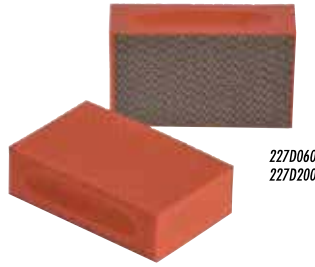

227D060
227D200

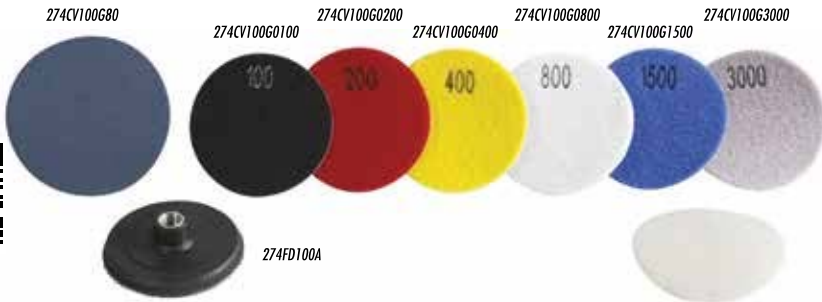

ACCESSORIES FOR CLOSER



FOAM WASHER

PACKAGE



CARTON BOX

CLOSER - DEVICE TO ACCOST TILES/SLABS

- To accost big tiles/slabs.

Part No.	Barcode	Box Icon	Description	Weight	Dimensions	Weight	Dimensions	Weight	Dimensions
185DAL01A	8024648079862	2	"Closer" device to accost tiles/slabs	4 Kg / 8.8 lbs	58x20xh 25 cm	19 5/8"x8"x10"	8,2 Kg / 18 lbs		

RUBBER ANTI-BOUNCING TILE BEATER

- To improve adhesive bounding and to expel air from underneath the slabs/tiles.
- Rubber bottom to prevent tiles/slabs damages.
- Sturdy galvanized steel structure.
- The off-set handle increases effectiveness.

Part No.	Barcode	Box Icon	Description	Weight	Dimensions	Weight	Dimensions	Weight	Dimensions
142G	8024648078582	6	Rubber tile beater	1,5 Kg / 3.3 lbs	145x350 mm / 5 3/4"x13 3/4"	40x40xh 15 cm / 5 3/4"x12 5/8"xh 4 3/4"	9,4 Kg / 20.7 lbs		

DIAMOND PADS

- To finish the edges of tiles / slabs after cutting.
- Available grains 60 and 200.

Part No.	Barcode	Box Icon	Description	Grain	Weight	Dimensions	Weight	Dimensions
227D060	8024648077578	5	Diamond pad 55x90 mm grain 60	60	55x90 mm	2 1/8"x3 1/2"	10 gr / 0.35 oz	55 gr / 1.9 oz
227D200	8024648077585	5	Diamond pad 55x90 mm grain 200	200	55x90 mm	2 1/8"x3 1/2"	10 gr / 0.35 oz	55 gr / 1.9 oz

DIAMOND PADS FOR EDGE AND SIDE FINISHING / POLISHING

- Use on angle grinder RPM: min 1.800 / MAX 4.000

Part No.	Barcode	Box Icon	Description	Material	Grain	Weight	Dimensions
274FDAG	8024648081469	1	Kit of 6 diamond pads	for agglomerates	Ø 100	80 gr / 2.8 oz	
274FDGP	8024648081476	1	Kit of 6 diamond pads	for porcelain	Ø 100	80 gr / 2.8 oz	
274FDGR	8024648081483	1	Kit of 7 diamond pads	for granite	Ø 100	90 gr / 3.2 oz	
274FDMA	8024648081490	1	Kit of 6 diamond pads	for marble	Ø 100	80 gr / 2.8 oz	
274FD100G0100	8024648081933	5	Diamond pad grain 100	-	Ø 100	gr.100 / 50 gr / 1.8 oz	
274FD100G0200	8024648081940	5	Diamond pad grain 200	-	Ø 100	gr.200 / 50 gr / 1.8 oz	
274FD100G0400	8024648081957	5	Diamond pad grain 400	-	Ø 100	gr.400 / 50 gr / 1.8 oz	
274FD100G0800	8024648081964	5	Diamond pad grain 800	-	Ø 100	gr.800 / 50 gr / 1.8 oz	
274FD100G1500	8024648081971	5	Diamond pad grain 1500	-	Ø 100	gr.1500 / 50 gr / 1.8 oz	
274FD100G3000	8024648081988	5	Diamond pad grain 3000	-	Ø 100	gr.3000 / 50 gr / 1.8 oz	
274CV100G80	8024648015648	5	Zirconium abrasive disc with Velcro attachment grain 80	-	Ø 115	gr.80 / 50 gr / 1.8 oz	
274FD100A	8024648081506	1	Pad with velcro Ø 100 mm - 14MA attachment	-	Ø 100	60 gr / 2.1 oz	



EQUIPMENTS FOR BIG TILES/SLABS UP TO 426X156 cm - (14'x5.2')